



ELEVATORS

SIDE DOOR 90 DEGREE ELEVATORS

PART NO.	TYPE	TONS	SIZE	WEIGHT
33854	SLX	100	1.660" - 5 1/2"	175
31239	SLX	150	3 1/2" - 8 5/8"	340
33950	SLX	150	9 5/8" - 10 3/4"	420
33982	SLX	150	11 3/4" - 13 3/8"	460
33632	SLX	150	16" - 20"	664
33175	SLX	150	24" - 30"	1075
33180	SLX	150	36"	2100
43239	SLX	250	4 1/2" - 8 5/8"	550
43950	SLX	250	9 5/8" - 10 3/4"	650
43982	SLX	250	11 3/4" - 13 3/8"	525
43632	SLX	250	16" - 20"	1000
43175	SLX	250	24" - 30"	1092
43180	SLX	250	36"	2200
29965	SX	350	6 5/8" - 13 3/8"	1076
29966	SX	350	16" - 20"	280
29964	SX	500	6 5/8" - 13 3/8"	1180
30729	SX	500	16" - 20"	1346
46950	SX	750	7 5/8" - 13 3/8"	2650

CENTER LATCH 18 DEGREE DRILL PIPE ELEVATORS

PART NO.	TYPE	TONS	SIZE	WEIGHT
30157	MG	100	2 3/8" - 5"	235
30156	RG	150	2 3/8" - 5"	330
13884	MGG	175	2 1/8" - 5"	52
35005	MGG	250	2 3/8" - 5 1/2"	571
31068	GG	350	2 3/8" - 5 1/2"	734
70013	HGG	500	2 7/8" - 6 5/8"	980

CENTER LATCH 90 DEGREE COLLAR TYPE ELEVATORS

PART NO.	TYPE	TONS	SIZE	WEIGHT
32387	TA	35	1.050" - 2 7/8"	55
32385	TA	65	1.660" - 2 7/8"	113
32386	TA	65	3 1/2" - 4 1/2"	150
32383	TA	100	2 3/8" - 2 7/8"	127
32384	TA	100	3 1/2" - 4 1/2"	157
29960	TA	100	5 1/2" - 8 5/8"	352
32754	TA	150	5" - 8 5/8"	413
25462	RA	125	2 3/8" - 3 1/2"	158
25459	RA	150	2 3/8" - 4 1/2"	220
13373	RA	250	3 1/2" - 7"	352
12942	RAA	350	4 1/2" - 5 1/2"	550

SINGLE JOINT TYPE ELEVATORS

PART NO.	TYPE	TONS	SIZE	WEIGHT
183	SJ	5	2 3/8" - 5 1/2"	47
184	SJ	5	5 3/4" - 7 5/8"	52
185	SJ	5	8 5/8" - 9 5/8"	68
186	SJ	5	10 3/4" - 13 5/8"	114
187	SJ	5	16" - 20"	158
188	SJ	5	21 1/2" - 24 1/2"	295
189	SJ	5	24" - 30"	412
200	SJ	6	36"	690

SUCKER ROD TYPE ELEVATORS

PART NO.	TYPE	TONS	SIZE	WEIGHT
84001	SR	20	5/8" - 3/4"	30
84002	SR	20	3/4" - 7/8"	30
84003	SR	20	1"	30
84004	SR	20	1 1/8"	31
84003P	SRP	20	5/8" - 1 1/8"	34
84018	PLATE		5/8" - 3/4"	0.25
84019	PLATE		3/4" - 7/8"	0.25
84020	PLATE		1"	0.25
84021	PLATE		1 1/8"	0.25

SLIP TYPE ELEVATORS - LESS SLIPS AND GUIDES

PART NO.	TYPE	TONS	SIZE	WEIGHT
28750	LYT	20	1 1/2" - 2 1/16"	57
29328	MYT	40	1.315" - 2 7/8"	157
23105	YT	75	1.315" - 3 1/2"	356
39284	HYT	150	2 3/8" - 3 1/2"	525
24140	YC	75	3 1/2" - 7"	441
24139	MYC	125	3 1/2" - 7"	465
55310	HYC	200	3 1/2" - 7 5/8"	982

Note: Slip type elevators sold without Slips Setting Rings or Guides
Slips sold with inserts and without setting rings

SLIPS - GUIDES - INSERTS - SETTING RINGS

LYT	SLIP	INSERT	NO.	SETTING RING
-----	------	--------	-----	--------------

2 1/16" X 1.050"	28745-7	29370	8	28735
2 1/16" X 1.315"	28745-2	28749	8	28736
3 1/16" X 1.660"	28745-3	28778	8	28784
2 1/16" X 1.900"	28745-4	28775	8	28783
2 1/16" X 2.000"	28745-5	28772	8	28737
2 1/16" X 2 1/16"	28745-6	28772	8	28782

MYT	SLIP	INSERT	NO.	SETTING RING
-----	------	--------	-----	--------------

2 7/8" X 1.315"	29343-7	29259	8	29354
2 7/8" X 1.660"	29343-6	29258	8	29353
2 7/8" X 1.900"	29343-5	29257	8	29352
2 7/8" X 2.000"	29343-4	29256	8	29351
2 7/8" X 2 1/16"	29343-3	29256	8	29350
2 7/8" X 2 3/8"	29343-2	29255	8	29345
2 7/8" X 2 7/8"	29343-1	24773	8	29348

YT	SLIP	INSERT	NO.	SETTING RING
----	------	--------	-----	--------------

2 7/8" X 1.315"	23108-11	29259	12	29001
2 7/8" X 1.660"	23108-10	29258	12	27810
2 7/8" X 1.900"	23108-9	29257	12	27811
2 7/8" X 2.000"	23108-8	29256	12	27821
2 7/8" X 2 1/16"	23108-7	29256	12	27812
2 7/8" X 2 3/8"	23108-6	29255	12	27694
2 7/8" X 2 7/8"	23108-4	24773	12	27695
3 1/2" X 2 7/8"	23108-3	30358	24	27695
3 1/2" X 3 1/2"	23108-5	24774	24	27813

HYT	SLIP	INSERT	NO.	SETTING RING
-----	------	--------	-----	--------------

2 7/8" X 2 3/8"	39259-4	29255	16	39214-1
2 7/8" X 2 7/8"	39259-2	24773	16	39214-2
3 1/2" X 2 7/8"	39258-4	30358	32	39214-3
3 1/2" X 3 1/2"	39258-2	24774	32	39214-4

YC & MYC

SIZE	SLIP	INSERT	NO.	GUIDE PL.	SETTING RING
------	------	--------	-----	-----------	--------------

4 1/2" X 3 1/2"	34931	24779	16	26827-1	34932
4 1/2" X 4"	26830	24781	16	26827	30209
4 1/2" X 4 1/2"	24072-5	16408	16	24071-4	30219
5 1/2" X 5"	24072-7	24783	16	24071	30220
5 1/2" X 5 1/2"	24072-2	16407	16	24071-1	30223
7" X 6 5/8"	24077-7	24748	24	24071-3	30226
7" X 7"	24077-1	16407	24	24071-2	30229

HYC	SLIP	INSERT	NO.	GUIDE PL.	SETTING RING
-----	------	--------	-----	-----------	--------------

4 1/2" X 3 1/2"	55509	24779	24	26827-1	55516
4 1/2" X 4"	55510	24781	24	26827	55517
4 1/2" X 4 1/2"	55511	16408	24	24071-4	55518
5 1/2" X 5"	55512	24783	36	24071	55519
5 1/2" X 5 1/2"	55513	16407	36	24071-1	55520
7" X 6 5/8"	55514	24748	48	24071-3	55521
7" X 7"	55515	16407	48	24071-2	55522
7 5/8" X 7 5/8"	70009	70010	48	24071-6	70012

ELEVATOR BORE CODES

DRILL PIPE BORE CODES

DRILL PIPE	T TYPE UPSET	TOOL JOINT	18° TAPERED	90° COLLAR
2 3/8	IU	API REG.		109
	EU	NC 26 (IF) WO OH SL H90	116	110
2 7/8	IU	API REG. XH	117	108
	EU	NC 37 (IF) WO OH SL H90	118	101
3 1/2	IU	API REG. FH	119	102
	EU	NC 38 (IF) WO OH SL H90	120	103
4	IU	NC 40 (FH) H90	121	104
	EU	NC 46 (IF) WO OH	122	105
4 1/2	IU	NC 46 (XH) FH H90	122	105
	EU	NC 50 (IF) WO OH	123	106
5	IFU	NC 50 (XH) 4 1/2 IF 5 1/2 FH	123	106
5 1/2	IEU	FH	124	107
	IFU	IF	678	
6 5/8	IEU	FH	740	

COLLAR TYPE DRILL PIPE

BORE CODE	TOP BORE A	BOTTOM BORE B
101	3 3/8	3 1/8
102	3 13/16	3 3/4
103	4 1/16	3 3/4
104	4 5/16	4 1/4
105	4 13/16	4 3/4
106	5 5/16	5 1/4
107	5 7/8	5 13/16
108	3 1/8	3 1/8
109	2 5/8	2 5/8
110	2 3/4	2 3/4
111	3 1/2	3 1/2
112	3 1/16	3 1/16
113	5 11/16	5 11/16
114	6 1/4	6 1/4
115	2 13/16	2 13/16

TUBING

TUBING SIZE (IN.)	STYLE	BORE CODE	TOP BORE A	BOTTOM BORE B
1.050 (3/4)	PLAIN (NU)	150	1 5/32	1 13/32
	UPSET (EU)	151	1 13/32	1 13/32
1.315 (1)	PLAIN (NU)	152	1 13/32	1 19/32
	UPSET (EU)	153	1 19/32	1 19/32
1.660 (1 1/4)	PLAIN (NU)	154	1 3/4	1 29/32
	UPSET (EU)	155	1 29/32	1 29/32
1.900 (1 1/2)	PLAIN (NU)	156	2	2 3/16
	UPSET (EU)	157	2 3/16	2 3/16
2 3/8	PLAIN (NU)	158	2 15/32	2 11/32
	UPSET (EU)	159	2 23/32	2 23/32
2 7/8	PLAIN (NU)	160	2 31/32	3 1/6
	UPSET (EU)	161	3 7/32	3 7/32
3 1/2	PLAIN (NU)	162	3 19/32	3 27/32
	UPSET (EU)	163	3 27/32	3 27/32
4	PLAIN (NU)	164	4 3/32	4 11/32
	UPSET (EU)	165	4 11/32	4 11/32
4 1/2	PLAIN (NU)	166 (129)	4 19/32	4 19/32
	UPSET (EU)	167	4 27/32	4 27/32

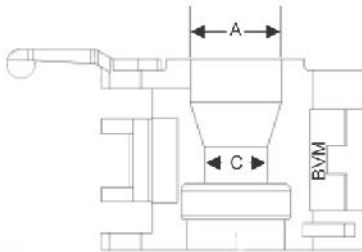

PLAIN DRILL COLLAR WITH LIFT PLUGS

COLLAR OD (IN.)	BORE CODE	TOP BORE	BEVEL C	BOTTOM BORE B
2 1/2	201	2 21/32	1/16	2 21/32
2 3/4	203	2 29/32	1/16	2 29/32
3	205	3 5/32	1/16	3 5/32
3 1/8	206	3 9/32	1/16	3 9/32
3 1/4	207	3 13/32	1/16	3 13/32
3 1/2	209	3 21/32	1/16	3 21/32
3 3/4	211	3 29/32	1/16	3 29/32
4	213	4 5/32	1/16	4 5/32
4 1/8	519	4 9/32	1/16	4 9/32
4 1/4	548	4 13/32	1/16	4 13/32
4 1/2	215	4 21/32	1/16	4 21/32
4 3/4	354	4 15/16	1/16	4 15/16
5	552	5 3/16	1/16	5 3/16
5 1/4	219	5 7/16	1/16	5 7/16
5 1/2	411	5 11/16	1/16	5 11/16
5 3/4	222	5 31/32	1/16	5 31/32
6	349	6 7/32	1/16	6 7/32
6 1/4	348	6 15/32	1/16	6 15/32
6 3/8	331	6 19/32	1/16	6 19/32
6 1/2	135	6 23/32	1/16	6 23/32
6 3/4	338	7	1/16	7
7	372	7 1/4	1/16	7 1/4
7 1/4	335	7 1/2	1/16	7 1/2
7 1/2	137	7 3/4	1/16	7 3/4
7 3/4	550	8	1/16	8
8	334	8 1/4	1/16	8 1/4
8 1/4	347	8 1/2	1/16	8 1/2
8 1/2	580	8 25/32	1/16	8 25/32
8 3/4	226	9 1/32	1/16	9 1/32
9	356	9 9/32	1/16	9 9/32
9 1/4	227	9 17/32	1/16	9 17/32
9 1/2	346	9 25/32	1/16	9 25/32
10	228	10 11/32	1/16	10 11/32
10 1/2	229	10 27/32	1/16	10 27/32
11	230	10 11/32	1/16	10 11/32

DRILL COLLAR WITH ZIP LIFT RECESS

COLLAR OD (IN.)	BORE CODE	TOP BORE	BEVEL C	BOTTOM BORE B
4 1/8	117	3 13/16	1/16	4 1/4
4 3/4	435	4 3/8	1/16	4 7/8
5 1/4	179	4 7/8	1/16	5 3/8
5 1/2	180	5 1/8	1/16	5 3/8
5 3/4	181	5 1/4	1/16	5 7/8
6	362	5 1/2	1/16	6 1/8
6 1/4	337	5 3/4	1/16	6 3/8
6 1/2	373	6	1/16	6 5/8
6 3/4	387	6 3/16	3/32	6 7/8
7	361	6 7/16	3/32	7 1/8
7 1/4	357	6 11/16	3/32	7 3/8
7 1/2	188	6 15/16	3/32	7 5/8
7 3/4	339	7 3/16	3/32	7 7/8
8	336	7 7/16	3/32	8 1/8
8 1/4	422	7 11/16	3/32	8 3/8
8 1/2	426	7 15/16	3/32	8 5/8
9	427	8 3/8	1/8	9 1/8
9 1/2	370	8 7/8	1/9	9 5/8
9 3/4	367	9 1/8	1/8	9 7/8
10	195	9 3/8	1/8	10 1/8
10 3/4	527	10 1/8	1/8	10 7/8
11	419	10 3/8	1/8	11 1/8
11 1/4	196	10 5/8	1/8	11 3/8

CASING

CASING SIZE (IN.)	BORE CODE	TOP BORE A	BOTTOM BORE B
4 1/2	129	4 19/32	4 19/32
4 3/4	130	4 27/32	4 27/32
5	131	5 3/32	5 3/32
5 1/2	132	5 5/8	5 5/8
5 3/4	133	5 7/8	5 7/8
6	134	6 1/8	6 1/8
6 5/8	135	6 3/4	6 3/4
7	136	7 1/8	7 1/8
7 5/8	137	7 3/4	7 3/4
8 5/8	139	8 25/32	8 25/32
9	140	9 5/32	9 5/32
9 5/8	141	9 25/32	9 25/32
9 7/8	649	10 1/32	10 1/32
10 3/4	142	10 29/32	10 29/32
11 3/4	143	11 15/16	11 15/16
12 3/4	850	12 15/16	13 15/16
13 3/8	144	13 9/16	13 9/16
13 5/8	596	13 13/16	13 13/16
16	145	16 7/32	16 7/32
18 5/8	146	18 7/8	18 7/8
20	147	20 1/4	20 1/4
21 1/2	148	21 25/32	21 25/32
22	688	22 9/32	22 9/32
24	630	24 5/16	24 5/16
24 1/2	149	24 13/16	24 13/16
26	650	26 11/32	26 11/32
28	690	28 11/32	28 11/32
30	644	30 3/8	30 3/8
36	660	36 7/16	37 7/16

