

Grooved End Connection

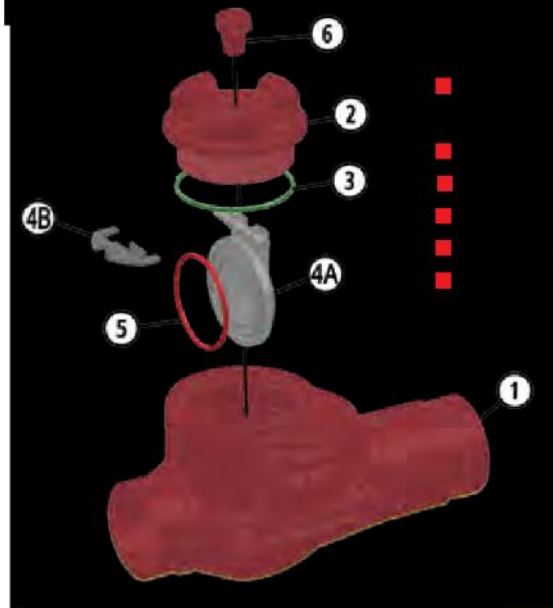

Series D Ductile Iron

- Top Entry Swing Check Valve
- 750 PSI WP
- 2" to 4"
- Threaded Body Construction



- Made Annealed Ductile Iron for Better Corrosion Resistance and Greater Yield Strength
- Weld Hinge-Works for Extended Life
- 316 Stainless Steel Disc Standard
- Precision Machined Grooves
- Designed by Design for Easier Bonnet Removal
- Meets Industry Standard

Material Description

ITEM	PART NAME	DESCRIPTION
1	Body	ASTM A395 Class 60-40-18 Fully Annealed
2	Bonnet	ASTM A395 Class 60-40-18 Fully Annealed
3	Bonnet Seal	Fluorocarbon
4A	Disc	Replaceable 316 Stainless Steel
4B	Disc Hanger	Stainless Steel
5	Disc Seal	Fluorocarbon
6	Pipe Plug	Carbon Steel

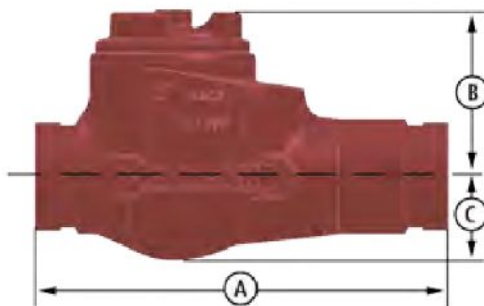

Dimensional Data

SIZE	CATALOG	PORT	WP	A	B	C	LBS.
2	2F-D32-GE	2	750	9	3.58	1.82	10
3	3F-D32-GE	3	750	10.75	4.50	2.45	20
4	4F-D32-GE	4	750	12	5.54	2.95	36