

Grooved End Connection



Series D Aluminum Bronze

- Top Entry Swing Check Valve
- 1000 PSI WP
- 2" to 4"
- Threaded Body Construction

- Enhanced Protection Against CO₂ and Saltwater Corrosion
- Replaceable Disc
- NACE Standard
- 316 Stainless Steel Disc Standard
- Improved by Design for Easier Bonnet Removal

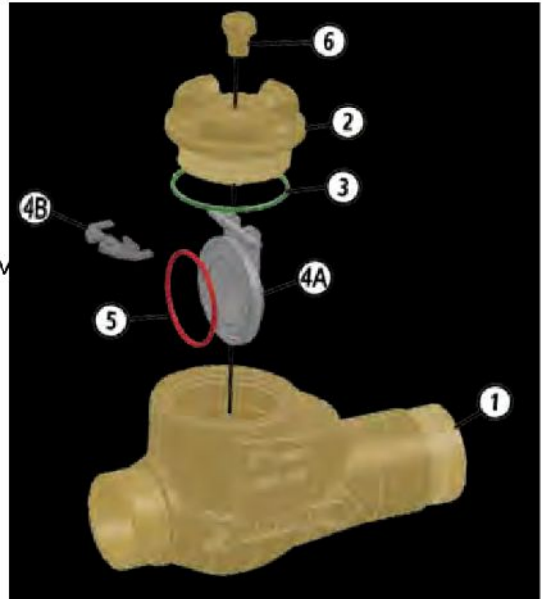

Material Description

ITEM	PART NAME	DESCRIPTION
1	Body	ASTM B148 9D (955)
2	Bonnet	ASTM B148 9D (955)
3	Bonnet Seal	Fluorocarbon
4A	Disc	Replaceable 316 Stainless Steel
4B	Disc Hanger	Stainless Steel
5	Disc Seal	Fluorocarbon
6	Pipe Plug	316 Stainless Steel

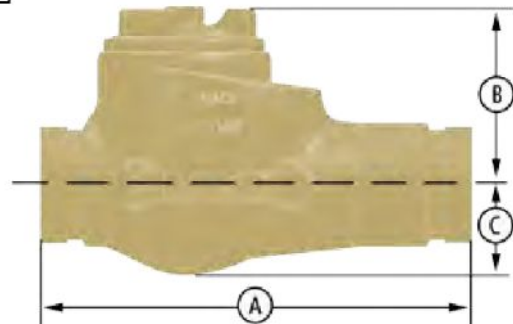

Dimensional Data

SIZE	CATALOG	PORT	WP	A	B	C	LBS.
2	2F-D44-GE	2	1000	9	3.58	1.82	9.75
3	3F-D44-GE	3	1000	10.75	4.50	2.45	21
4	4F-D44-GE	4	1000	12	5.54	2.95	35