

# Grooved End Connection

## Series S Ductile Iron

- Lever Operated Ball Valve
- To 1000 PSI WP
- 2" Through 4"
- Threaded Body Construction

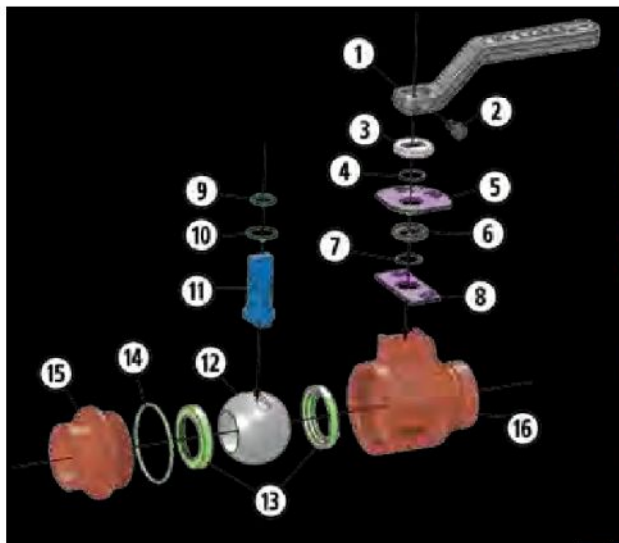

- High Grade Annealed Ductile Iron for Better Corrosion Resistance and Greater Yield Strength
- Multi-Seal Seats
- Fire Safe Design
- NACE Valves Include 316 Stainless Steel Ball and Stem
- Rugged Locking Device Standard
- Maintenance Free

### Material Description

PART NAME	MATERIAL (STANDARD)	MATERIAL (NACE)
Handle*	Carbon Steel/Ductile Iron	Carbon Steel/Ductile Iron
Handle Bolt	Standard Hex Bolt	Standard Hex Bolt
Weather Guard	Polyethylene	Polyethylene
Lock Plate Retainer	Carbon Spring Steel	Carbon Spring Steel
Lock Plate	Carbon Steel	Carbon Steel
Dust Cover	Polyethylene	Polyethylene
Stop Plate Retainer	Carbon Spring Steel	Carbon Spring Steel
Stop Plate	Carbon Steel	Carbon Steel
Stem O-Ring	Buna-N	Fluorocarbon
Stem Seal	TFE	TFE
Stem	Carbon Steel	316 Stainless Steel
Ball	Carbon Steel Nickel Chrome Plated	316 Stainless Steel
Ball Seat	Nylon (TFE Optional)	Nylon (TFE Optional)
Body O-Ring	Buna-N	Fluorocarbon
End Adapter	ASTM A395 Class 60-40-18 Fully Annealed	ASTM A395 Class 60-40-18 Fully Annealed
Body	ASTM A395 Class 60-40-18 Fully Annealed	ASTM A395 Class 60-40-18 Fully Annealed

\*Handle is optional. Ball valves can also be operated with a standard open-end wrench.

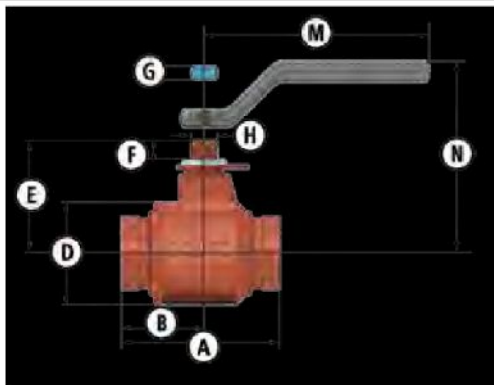

### Dimensional Data

SIZE	CATALOG NUMBER		PORT	WP	A	B	D	E	F	G	H	M	N	LBS.	HANDLE	Cv
	STANDARD TRIM CARBON STEEL BALL & STEM	NACE TRIM 316 SS BALL & STEM														
2x1.5x2	2R-S32-GE	2R-S32N-GE	1.5	750	5.12	2.88	3.37	3.62	.82	.434	.873	7.25	5.25	7.5	P-4128-CS	140
2x1.5x2	2R-S42-GE	2R-S42N-GE	1.5	1000	5.12	2.88	3.37	3.62	.82	.434	.873	7.25	5.25	7.5	P-4128-CS	140
3x2x3	3R-S32-GE	3R-S32N-GE	2	750	7.25	3.50	4.50	4.37	.75	.497	.998	10.25	6.20	17	P-4129-CS	200
3x2x3	3R-S42-GE	3R-S42N-GE	2	1000	7.25	3.50	4.50	4.37	.75	.497	.998	10.25	6.20	17	P-4129-CS	200
4x3x4	4R-S32-GE	4R-S32N-GE	3	750	8.87	4.50	6	5.75	.87	.747	1.373	20	7.75	34	P-4127-DI	550