

# Grooved End Connection

## Series S Aluminum Bronze

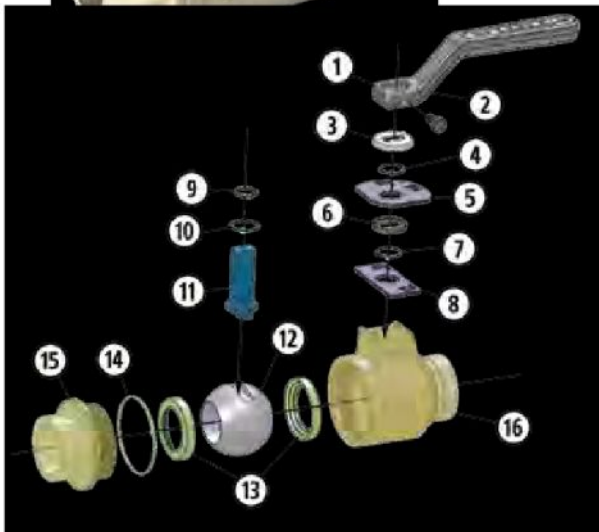

- Lever Operated Ball Valve
- 1000 PSI WP
- 2" Through 4"
- Threaded Body Construction



- Enhanced Protection Against CO<sub>2</sub> and Saltwater Corrosion
- Multi-Seal Seats
- Fire Safe Design
- NACE Standard
- Rugged Locking Device Standard
- Maintenance Free

### Material Description

ITEM	PART NAME	MATERIAL NACE (STANDARD)
1	Handle*	Carbon Steel/Ductile Iron
2	Handle Bolt	Standard Hex Bolt
3	Weather Guard	Polyethylene
4	Lock Plate Retainer	Stainless Steel
5	Lock Plate	Stainless Steel
6	Dust Cover	Polyethylene
7	Stop Plate Retainer	Stainless Steel
8	Stop Plate	Stainless Steel
9	Stem O-Ring	Fluorocarbon
10	Stem Seal	TFE
11	Stem	316 Stainless Steel
12	Ball	316 Stainless Steel
13	Ball Seat	Nylon (TFE Optional)
14	Body O-Ring	Fluorocarbon
15	End Adapter	ASTM B148-9D (955)
16	Body	ASTM B148-9D (955)

\*Handle is optional. Ball valves can also be operated with a standard open-end wrench.

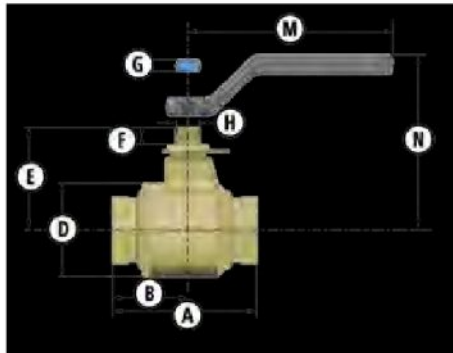

### Dimensional Data

SIZE	CATALOG NUMBER NACE TRIM 316 SS BALL & STEM	PORT	A	B	D	E	F	G	H	M	N	LBS.	HANDLE	Cv
2x1.5x2	2R-S44N-GE	1.5	5.12	2.88	3.37	3.62	.62	.434	.673	7.25	5.25	7.5	P-4128-CS	140
3x2x3	3R-S44N-GE	2	7.25	3.50	4.50	4.37	.75	.497	.996	10.25	6.20	16	P-4129-CS	200
4x3x4	4R-S44N-GE	3	8.87	4.50	6	5.75	.87	.747	1.373	20	7.75	34	P-4127-DI	550